

COLD DRAWN GUIDE RAILS / SOĞUK ÇEKİLMİŞ RAYLAR

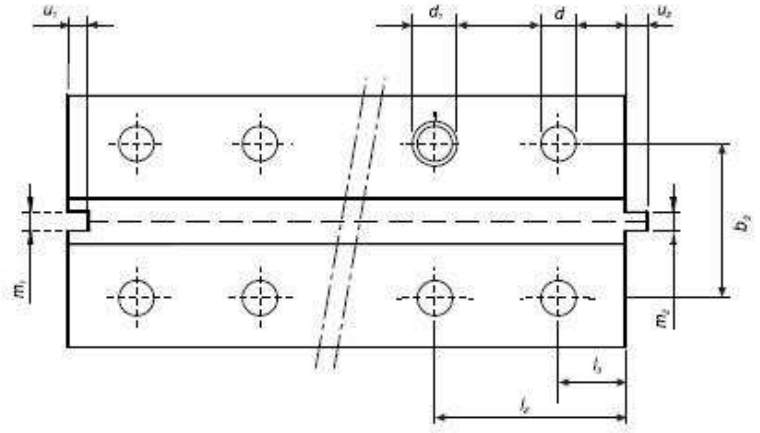
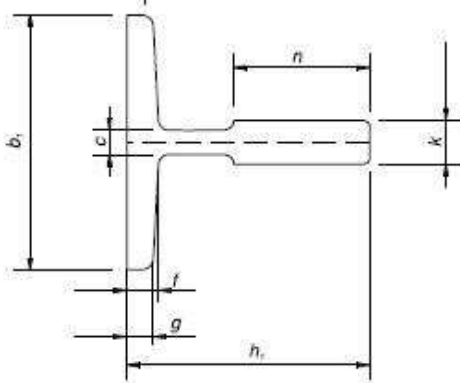

V max: 1 m/s

Counterweight guide's physical dimensions / Karşı ağırlık rayı fiziksel ölçüler (mm)								
TS ISO 7465 Mart 2011	b ₁	h ₁	k	p	m ₁	m ₂	u ₁	u ₂
	Tolerances / Toleranslar							
	±1	±0,2	±0,15	±0,5	$\begin{matrix} +0,06 \\ 0 \end{matrix}$	$\begin{matrix} 0 \\ -0,06 \end{matrix}$	±0,1	±0,1
T50/A	50	50	5	5	2	1,95	2,5	2

Physical dimensions / Fiziksel ölçüler (mm)											
TS ISO 7465 Mart 2011	b ₁	h ₁	k	n	c	f	g	m ₁	m ₂	u ₁	u ₂
	Tolerances / Toleranslar										
	±1,5	±0,1	$\begin{matrix} +0,1 \\ 0 \end{matrix}$	$\begin{matrix} +3 \\ 0 \end{matrix}$	-	±0,75	±0,75	$\begin{matrix} +0,06 \\ 0 \end{matrix}$	$\begin{matrix} 0 \\ -0,06 \end{matrix}$	±0,1	±0,1
T70/A	70	65	9	34	6	8	6	3	2,97	3,5	3
T82/A	82	68	9	34	7,5	8,25	6	3	2,97	3,5	3
T89/A	89	62	16	34	10	11,1	7,9	6,4	6,37	7,14	6,35
T90/A	90	75	16	42	10	10	8	6,4	6,37	7,14	6,35

Technical Characteristics / Teknik özellikler									
TS ISO 7465 Mart 2011	S	q ₁	e	I _{x-x}	W _{x-x}	i _{x-x}	I _{y-y}	W _{y-y}	i _{y-y}
	cm ²	Kg/m	cm	cm ⁴	cm ³	cm	cm ⁴	cm ³	cm
T50/A	4,75	3,73	1,43	11,24	3,15	1,54	5,25	2,1	1,05
T70/A	9,4	7,379	2,034	40,95	9,169	2,087	18,86	5,389	1,417
T82/A	10,91	8,564	1,998	49,31	10,27	2,126	30,17	7,358	1,663
T89/A	15,77	12,38	2,032	59,83	14,35	1,948	52,41	11,78	1,823
T90/A	17,25	13,54	2,612	102	20,86	2,431	52,48	11,66	1,744

Holes and Fishplates / Bağlantı pabuçları								Cıvata TS EN 4017	Tırnak DIN 7168
TS ISO 7465 Mart 2011	d	l ₁	l _{2f}	l _{3f}	b ₂	b ₃	V _{min}		
	Tolerances / Toleranslar								
		$\begin{matrix} +3 \\ 0 \end{matrix}$	±0,2	±0,2	-	±0,2	$\begin{matrix} +3 \\ 0 \end{matrix}$		
T50/A	9	200	75	25	50	30	8	M8X25	M1
T70/A	13	250	105	25	70	42	10	M12X35	M2
T82/A	13	216	81	27	80	50,8	10	M12X35	M2
T89/A	13	305	114,3	38,1	90	57,2	13	M12X40	M3
T90/A	13	305	114,3	38,1	90	57,2	13	M12X40	M3

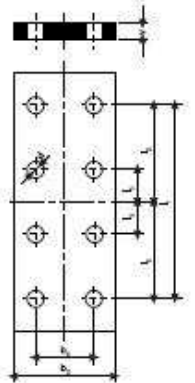

STANDARTS/STANDARTLAR
LENGHT/BOY
PACKING/PAKET
END PROTECTION/KORUMA
STEEL/ÇELİK

TS ISO 7465 / Mart 2011
5000mm ± 2mm / 2500mm ± 2mm
Bundles 1000kg APPROX
Coated by Anticorit BW 366 to remove easily with usual disolvents
ISO 630 / E 235 B

- In keeping the rights to modify the specifications written in this page without notice.
- Bu sayfada yazılı olan spesifikasyonları bildirişiz deęiřtirme hakkımız saklıdır.